

### Unleash the power

The Shuttle XPC Barebone SP35P2 Pro is designed for users who have exceptional demands in terms of system performance, hardware and future compatibility. As a result, it features an especially high performance Intel P35 Express chipset and supports the latest generation of 45 nm dual core and quad core processors with 1333 MHz system bus. A fingerprint scanner ensures greater system protection. The Speed-Link function allows for the direct transfer of data between two PCs via USB cable, and a particularly efficient, 80 PLUS certified 400-Watt power supply takes care of this black powerhouse without compromising its performance. This aluminium SFF PC, through its integrated PCI Express X16 slot, supplies all the bandwidth necessary to accommodate the quickest graphics cards and, thereby, run professional graphics applications and complex 3D games.

### Prima XPC Barebone SP35P2 Pro



Note: optical drive sold separately. Images for illustration purposes only.

### Feature Highlight

<b>P2 chassis</b>	<ul style="list-style-type: none"> <li>Black aluminum chassis</li> <li>Drive bays: 1x 5.25", 3x 3.5"</li> </ul>
<b>Chipset</b>	<ul style="list-style-type: none"> <li>Intel P35 Express + ICH9R</li> </ul>
<b>CPU</b>	<ul style="list-style-type: none"> <li>Socket 775</li> <li>Supports Intel Core 2 Quad/Extreme/Duo, Pentium Dual-Core, Celeron 4xx</li> <li>Supports 45 und 65nm CPUs</li> <li>Supports 1333, 1066 and 800MHz FSB</li> <li>Shuttle 3 zones heat-pipe cooling system</li> </ul>
<b>Slots</b>	<ul style="list-style-type: none"> <li>1x PCI-Express (x16), 1x PCI, 1x Mini-PCIe</li> </ul>
<b>Memory</b>	<ul style="list-style-type: none"> <li>Supports 4x DDR2-667/800 DDR2-1066 in overlocking mode*</li> <li>Up to 8 GBytes total size</li> </ul>
<b>Drive connectors</b>	<ul style="list-style-type: none"> <li>4x SATA (internal) + 2x eSATA (external) supports RAID 0, 1, 5, 10 and JBOD</li> <li>1x IDE ATA 100, 1x floppy disk drive</li> </ul>
<b>Pro-Features</b>	<ul style="list-style-type: none"> <li>Fingerprint recognition technology</li> <li>Speed-Link (connects 2 PCs via USB)</li> </ul>
<b>Other connectors</b>	<ul style="list-style-type: none"> <li>8-ch HD-audio, SPDIF in/out</li> <li>2x Firewire, GigaBit LAN</li> <li>USB 2.0 (1x front, 6x rear, 4x onboard)</li> <li>USB Speed-Link</li> </ul>
<b>Power supply</b>	<ul style="list-style-type: none"> <li>400 Watt ATX power supply (80 PLUS)</li> </ul>
<b>Application</b>	<ul style="list-style-type: none"> <li>Gaming</li> </ul>

Product ID: SP35P2 Pro  
UPC (see bar code)



## Shuttle XPC Barebone SP35P2 Pro – Special Product Features



### Shuttle XPC Prima Series offering extreme performance

Shuttle has introduced the XPC Prima series, with its revolutionary high performance models, for professional and performance demanding applications whether they be at work, everyday or for high-tech gaming.

### Supports 1333 MHz FSB and new 45nm processors

This Shuttle product supports the Intel® Core™ 2 Duo and Intel® Core™ 2 Quad processors with up to 1333 MHz front side bus and even the new 45nm Core™ 2 Multi-core processors. Multi core brings multi power!

### OASIS Cooling Technology

The newly designed OASIS cooling technology deliver a unique system of heat-sinks covering the MOSFET modules, the north bridge as well as the south bridge that effectively dissipates heat without the use of fans. Featuring an all-new Heat pipe design, Shuttle OASIS allows users to enjoy longer component lifetime through lower temperatures, added system stability and silent operation.

### 80 PLUS® Certified Power Supplies

The 80 PLUS® performance specification requires power supplies in computers and servers to be 80% or greater energy-efficient.

### Fingerprint reader

With an added a layer of security protection thru the integrated biometric fingerprint reader, you can keep your digital identity and data more secure and no longer worry about having to memorize for memorizing multiple passwords.

### Innovative Speed-Link technology

File sharing among two PCs has never been easier with the innovative Speed-Link technology, simply connects both systems thru a USB cable without having the hassle of driver installation or worry about insufficient space of a DVD disc.

### User Friendly Dynamic OverClock (DOC) feature\*)

The user can easily overclock the system through the bios from 3%,5%,7% to 10%

### New Era of All-Solid Capacitor Shuttle Mainboards

By using all-solid capacitors Shuttle mainboards provide industry leading stability, reliability and longevity for PC gaming and entertainment systems. The average lifespan for a solid capacitor is more than six times greater than the more common and less expensive electrolytic capacitors.



### Supports up to three hard disks and 4 DDR2 modules

The P2 chassis design features four DDR2 memory slots and supports an incredible 8GB of RAM besides three harddisks (or two harddisks and an 3.5" card reader) and an optical drive - which is plenty for the case capacity of just 15 litres.



### Supports RAID functionality

The south bridge incorporate six Serial ATA connectors with high performance RAID functions in RAID 0, 1, 5, 0+1, and JBOD. It is the ideal solution to enhance hard disk performance and data back up protection without the cost of add-on cards.

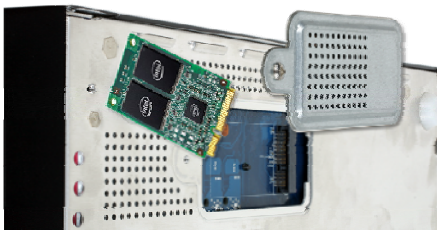

### Mini PCIe slot supports Intel Turbo Memory module

There is one Mini-PCIe x1 slot at the bottom of the chassis which supports Intel® Turbo Memory (codename: Robson). Intel® Turbo Memory lets your system actually learn your habits to provide better system response. That's because it stores frequently used information near the processor, where it's more quickly available.



### Supports Windows Vista Premium

Breathtaking Windows Aero™ 3D visual interface and a host of groundbreaking new features, Windows® Vista™ Premium promises to deliver a streamlined computing experience designed to fundamentally change how users view, find and organize their digital information.



### Color slots design

Easily recognize color codes provides an easier way to install the devices such as Power switch, USB, PCI-E, PCI, DDR2.

#### **\*) Overclocking Warning:**

Please note there is a certain risk involved with overclocking, including adjusting the setting in the BIOS or using third-party overclocking tools. Overclocking may affect your system stability or even cause damage of the components and devices of your system. It is done at your own risk and expense. Shuttle cannot be held responsible for possible damage caused by overclocking.

## Shuttle XPC Barebone SP35P2 Pro Specifications

<b>Special Pro-Features</b>	Fingerprint recognition technology Speed-Link - easily connect 2 PCs via USB and share data
<b>Chassis</b>	P2-type aluminum chassis, color: black storage bays: 1 x 5.25", 3 x 3.5" (2 internal) stealthed drive doors dimensions: 32.5 x 22 x 21 cm (LWH) weight: 4.2 kg net / 6.0 kg gross
<b>Mainboard</b>	Shuttle FP35, Shuttle form factor, proprietary design for XPC SP35P2 Pro Chipset: Intel P35 Express (MCH, codename: Bearlake-X) + ICH9R (I/O Controller Hub) Solid Capacitors for excellent heat resistance for enhanced system durability Color slots/connectors design (Power switch, USB, PCIe, PCI) Dimensions: 20.5 x 28 cm
<b>Power Supply</b>	400 Watt ATX mini PSU, AC input voltage: 100~240V 80 PLUS® certified (80% or greater energy-efficient) Dimensions: 85(W) x 83(H) x 150(D) mm Connectors: 2x3 pin (CPU power), 2x4 pin (mainboard power) Active PFC circuit (Power Factor Correction)
<b>Processor Support</b>	Socket 775 supports Single, Dual and Quad Core processors from Intel with Core technology and 800, 1066 or 1333MHz front side bus: Supports Core 2 Quad/Extreme/Duo, Pentium Dual-Core and Celeron 4xx Supports Pentium 4/D processors at 800MHz FSB. Supports processors with 65nm and 45nm process technology. Processors with 533MHz FSB are not supported. Please refer the support list for detailed processor support information.
<b>Over-clocking *)</b>	CPU frequency, CPU voltage, RAM frequency, RAM voltage Dynamic Overclock (DOC) feature: Easily overclock from 3/5/7/10% through the BIOS.
<b>Processor Cooling</b>	New Shuttle I.C.E. heat-pipe module (Integrated Cooling Engine) SilentX Cooling and Noise Reduction Technology advanced Heatpipe technology, linear fan control. 3 independent cooling areas. OASIS Cooling Technology: additional fanless heat-pipe design covering the MOSFET modules (VRM), north- and southbridge
<b>Memory Support</b>	4 x 240 pin slots, supports Dual Channel supports DDR2-667/800 SDRAM memory (DDR2-1066 in overclocking mode*) max. 2 GB per DIMM, up to a total size of 8 GB

©2006 by Shuttle Computer Handels GmbH (Germany). All information subject to change without notice. Pictures for illustration purposes only.

<p><i>Expansion Slots</i></p>	<p>1x PCI-Express x16 Steckplatz          Supports Dual-slot (double-width) graphics cards          1x PCI 32 bit slot          1x Mini-PCIe x1 slot at the bottom of the chassis          supports Intel Turbo Memory (codename: Robson)</p>
<p><i>8-channel Audio</i></p>	<p>7.1 channel High Definition Audio with Realtek ALC888 codec          analog: line-out (8-ch), line-in, microphone, CD-in, AUX          digital: optical S/PDIF-in, optical and coaxial S/PDIF-out</p>
<p><i>Gigabit-LAN Controller</i></p>	<p>Marvell 88E8056 Ethernet network controller          With PCI Express interface          IEEE 802.3u 1000Base-T compliant          Supports 10 / 100 / 1.000 MBit/s operation          Supports Wake-on-LAN</p>
<p><i>Firewire-Controller</i></p>	<p>IEEE1394 Firewire controller TI TSB43AB22A          Complies with 1394 OHCI specification revision 1.0          2 Firewire connectors (front and rear)          Supports 400Mb/s, 200Mb/s, 100Mb/s data transfer rate</p>
<p><i>Drive connectors</i></p>	<p>Serial-ATA II, 3 Gb/s (300 MB/s) bandwidth          4x internal (SATA) plus 2x external (eSATA)          Intel Matrix Storage Technology enabled striping and mirroring          Supports RAID 0, 1, 5, 10 and JBOD on just two or three hard disk drives          Supports Native Command Queuing (NCQ)          1x IDE ATA 100 drives (JMicron JMB368 Controller)          1x floppy disk drive</p>
<p><i>Front panel connectors</i></p>	<p>Microphone          Headphone (Line-out)          USB 2.0          USB Speed-Link with Speed-Link button          Firewire (Mini 4 pin connector)          Fingerprint recognition          Power button          Reset button          Power indicator (blue LED)          HDD indicator (orange LED)</p>
<p><i>Back panel connectors</i></p>	<p>6x USB 2.0          Firewire (6 pin)          GigaBit LAN (RJ45)          2x External Serial ATA Hotplug (eSATA)          8-ch Audio line-out (2x rear/front, bass/center, surround/back)          Digital Audio S/PDIF: optical in/out, coaxial out          Audio Line-in          Clear CMOS button          Perforation for optional Wireless LAN Antenna</p>

<p><i>Other connectors</i></p>	<p>4x USB 2.0 (two sets with 2x5 pins)            4x fan connectors (3x 4 pins, 1x 3 pins)            Headers for PS/2 mouse and PS/2 keyboard</p>
<p><i>Accessories</i></p>	<p>XPC Installation Guide            XPC 32/64bit Driver CDRom for Windows XP/Vista            Data cables: 1x floppy, 1x PATA, 2x SATA (PATA/SATA preinstalled)            Power Cord            Screws, Heatsink Compound</p>

**\*) Overclocking Warning**

Please note there is a certain risk involved with overclocking, including adjusting the setting in the BIOS or using third-party overclocking tools. Overclocking may affect your system stability or even cause damage of the components and devices of your system. It is done at your own risk and expense. Shuttle cannot be held responsible for possible damage caused by overclocking.

Shuttle XPC Barebone SP35P2 Pro – Connectors and Components

Front Panel

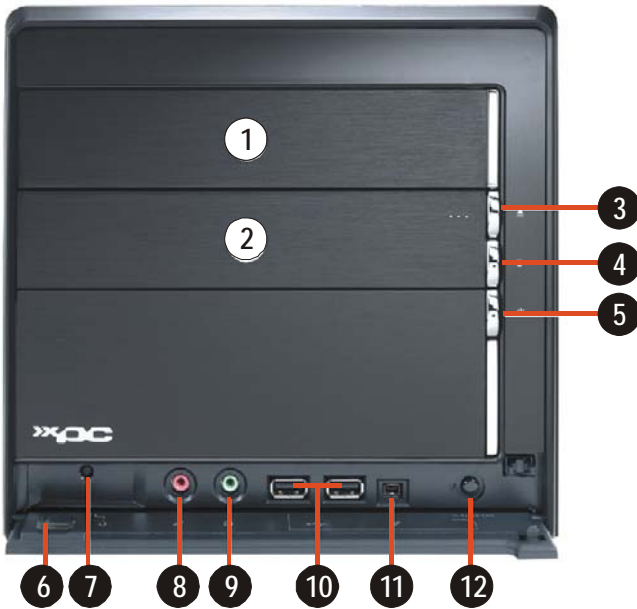

Back Panel

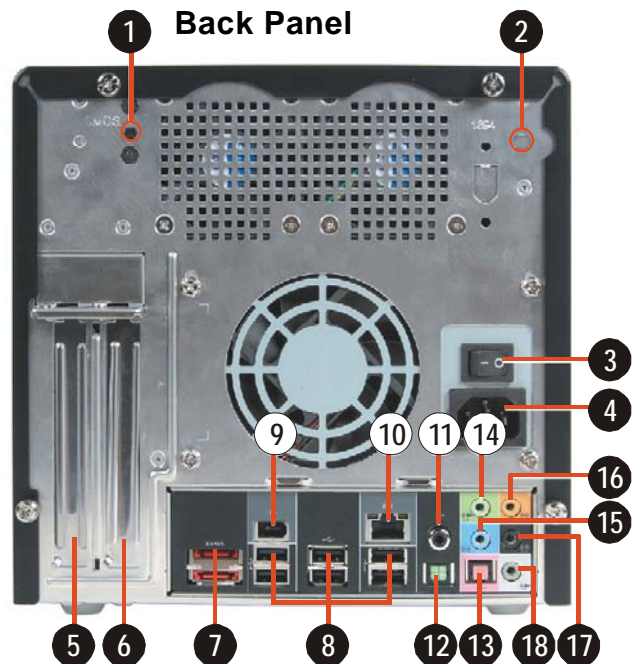

Mainboard

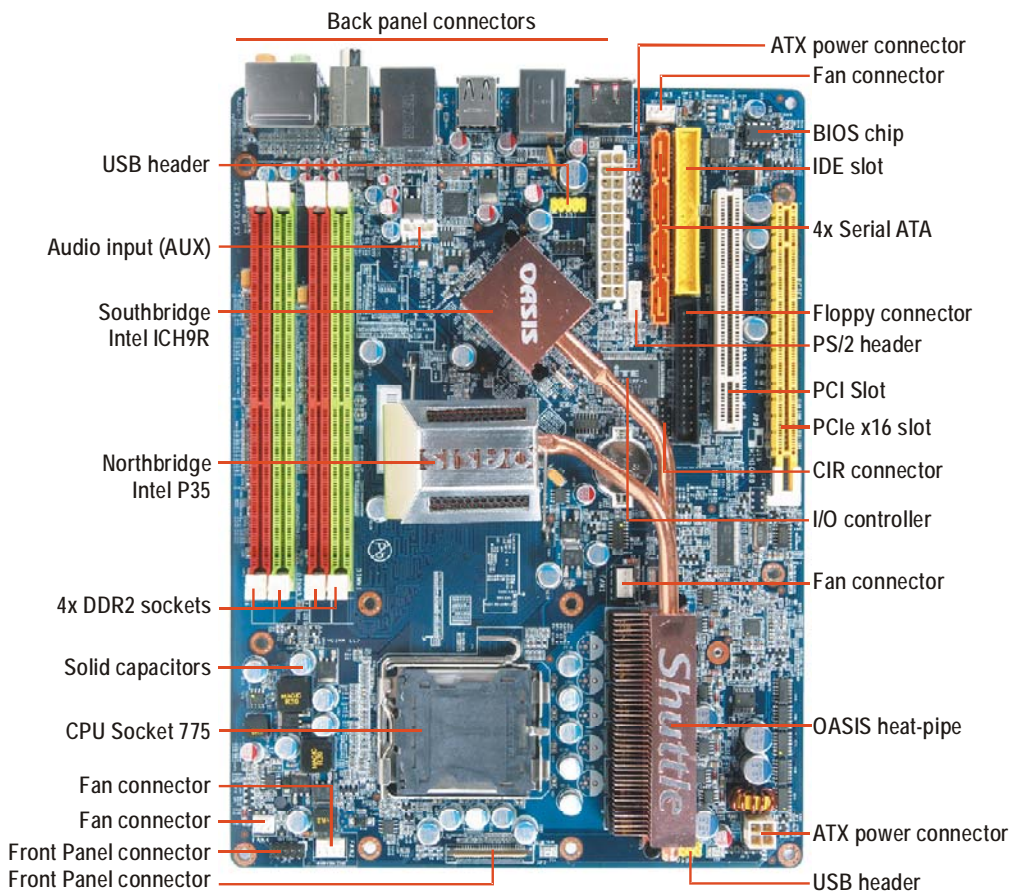

**Front Panel**

- 1 5.25" bay
- 2 3.5" bay
- 3 Eject button
- 4 HDD LED
- 5 Power Switch & LED
- 6 Fingerprint sensor
- 7 Reset Button
- 8 Microphone input
- 9 Headphone output
- 10 USB 2.0 Ports
- 11 Mini Firewire port (1394)
- 12 Speed-link on/off

**Back Panel**

- 1 Clear CMOS button
- 2 Wireless LAN perforation
- 3 AC Power Switch
- 4 AC Power Socket
- 5 PCI Express x16 slot
- 6 PCI slot
- 7 External SATA ports
- 8 USB 2.0 ports
- 9 Firewire port (1394)
- 10 Gigabit LAN ports
- 11 S/PDIF out (coaxial)
- 12 S/PDIF out (optical)
- 13 S/PDIF in (optical)
- 14 Line out (front)
- 15 Line in
- 16 Line out (center/bass)
- 17 Line out (back)
- 18 Line out (side)

© 2006 by Shuttle Computer Handels GmbH (Germany). All information subject to change without notice. Pictures for illustration purposes only.